

SMW Wideband X-Line



Switchable Dual Band LNB

Five standard models with different LOs. Comes with low phase noise, low noise figure, F-connector and two-year warranty. Options include high stability LO, low gain, low output VSWR and N-connector.

All our LNBs are individually hand tuned to get the very best performance available for each unit. Quality and long term reliability is also essential. Therefore are all LNBs tested according to a very extensive test program, which includes heating, cooling, water-proof testing and rigorous electrical testing.

Swedish Microwave was founded 1986 and, within Europe, is the oldest manufacturer of LNBs. In the standard product range we have DRO-LNBs, PLL-LNBs, LNAs, Block Downconverters (BDC), Up- & Down Converters, Quattro LNBs, Twin LNBs, Ortho mode transducers (OMT), Line Amplifiers and Feed horns.

Swedish Microwave is today one of the leading manufacturers of microwave components needed for satellite receiving equipment and other industrial products.

Specification SMW X-Line

SMW	X-Line type A	X-Line type B	X-Line type C
Frequency range	10.95-11.95 / 11.95-12.75 GHz	10.95-11.7 / 11.7-12.75 GHz	10.7-11.7 / 11.7-12.75 GHz
LO frequency	Band 1 10.0 GHz Band 2 11.0 GHz	10.0 GHz 10.75 GHz	9.75 GHz 10.75 GHz
Output frequency	Band 1 950 - 1950 MHz Band 2 950 - 1750 MHz	950 - 1700 MHz 950 - 2000 MHz	950 - 1950 MHz 950 - 2000 MHz

SMW	X-Line type E	X-Line type G
Frequency range	10.7-11.7 / 11.7-12.75 GHz	10.95-11.7 / 12.25-12.75 GHz
LO frequency	Band 1 9.75 GHz Band 2 10.6	10.0 GHz 11.3 GHz
Output frequency	Band 1 950 - 1950 MHz Band 2 1100 - 2150 MHz	950 - 1700 MHz 950 - 1450 MHz

General Specification

SMW X-Line

Noise figure, typical	0.8 dB
Gain	52 +/- 3 dB
Gain variation	+/- 0.3 dB within 30 MHz
LO stability (over temp.)	+/- 3 MHz
LO Phase noise typical	-75 dBc @ 1 kHz -85 dBc @ 5 kHz -95 dBc @ 10 kHz -110 dBc @ 100 kHz -120 dBc @ >1 MHz
LO radiation	-50 dBm
Image rejection	50 dB min
1 dB gain compression point	+5 dBm
Input	WR-75 waveguide
Output	F-connector, 75 ohm, water proof
Output VSWR	2.0:1
DC power	Band 1 11.5 - 14.0 V Band 2 16.0 - 19.0 V
Current	140 mA typ
Temperature range	-30 to +60°C
Weight	230 g
Options	Low gain Customized LOs, 9.75-11.475 GHz High stability LO, +/- 1 MHz over temp. High stability LO, +/- 1.5 MHz over temp. High stability LO, +/- 2 MHz over temp. Low output VSWR, 1.55:1 N-connector 50 ohm Extended frequency range

Accessories

Plastic covers

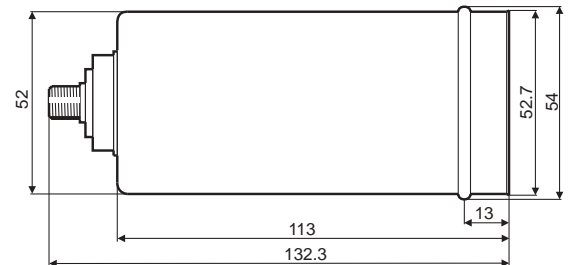
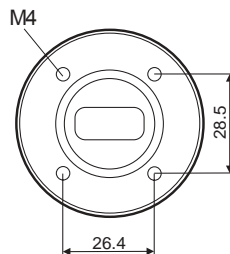

Box 230
591 23 MOTALA, SWEDEN
Tel. +46 141 21 61 35
Fax. +46 141 21 52 24
e-mail: info@smw.se
Website: <http://www.smw.se>